



## Chassis Conversion Kit Installation Instructions

### Kit contents:

- Rear upper suspension link (assembled with angled rod ends and hollow balls) (2)
- Rear lower suspension link (assembled with standard rod ends and hollow balls) (2)
- Front inner fenders (left and right)
- Rear inner fenders (left and right)
- Short female half shaft
- Battery tray
- 3x8mm FCS (4)

### Tools required:

- 2.0mm hex wrench
- 1.5mm hex wrench

Retain and reuse all parts except where indicated **X**

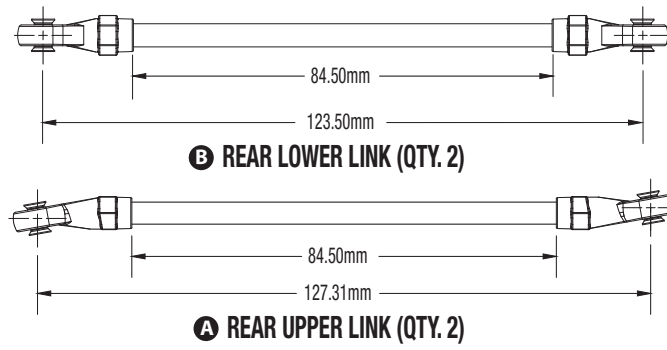

### Rear Center Driveshaft Assembly

#### Align Phasing Marks

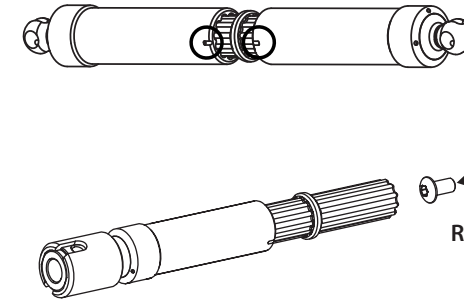

### Driveshaft Length Indicators

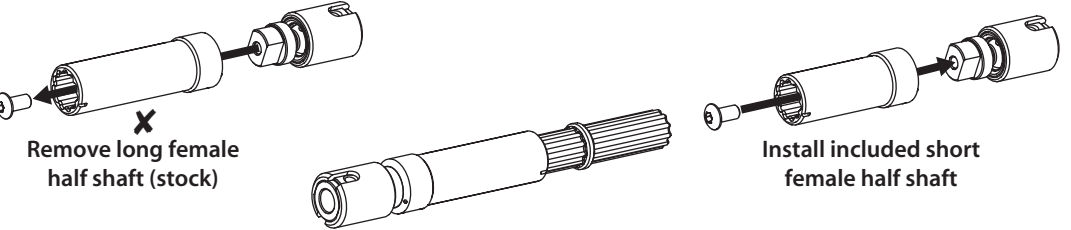
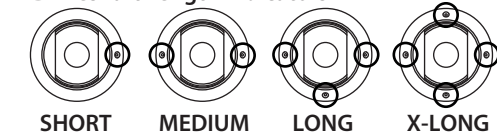

### 1. Remove shock towers

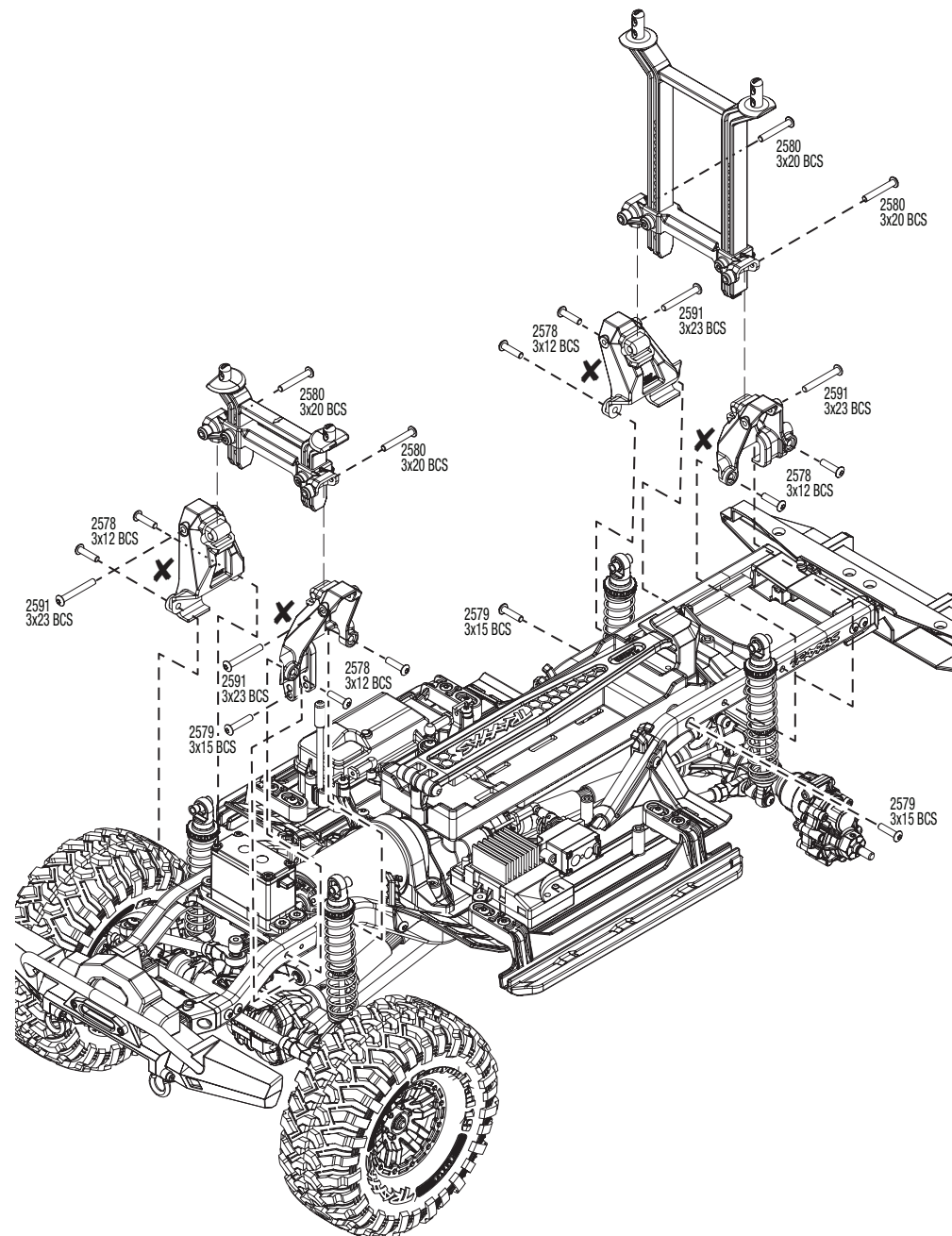

### 2. Install chassis-mounted inner fenders

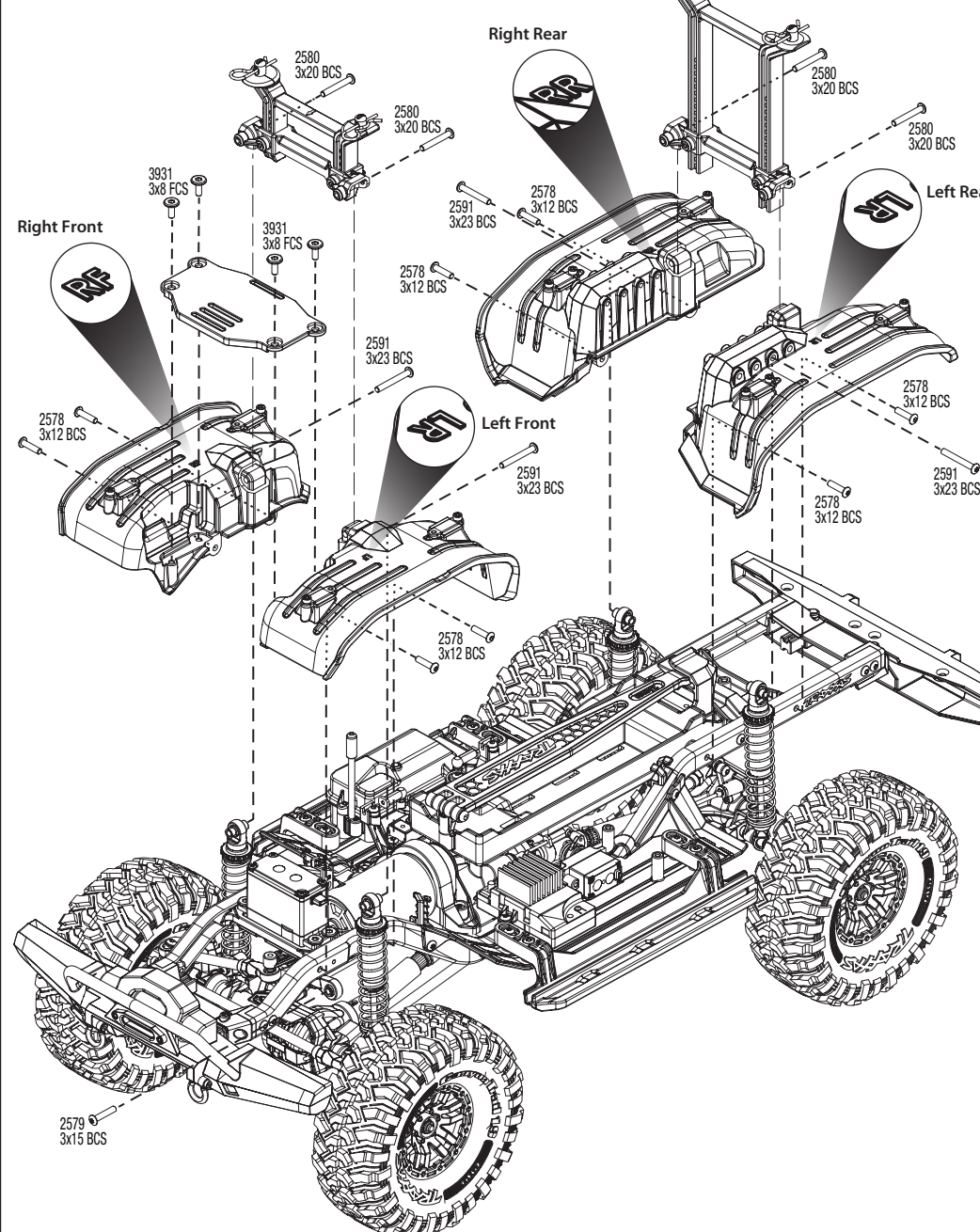

### 3. Remove rear center driveshaft and rear suspension links; install new driveshaft and rear suspension links

